

Series 213 Product Overview
Features:

- Low profile
- Large handle clearance in the open position
- Available in stainless steel

Applications:

- Assembly
- Checking fixtures
- Closures
- Woodworking

Also Available:

See page 8.1 for accessories
Accommodates M5 or #10 spindle accessory

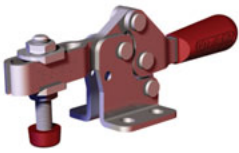
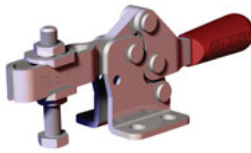
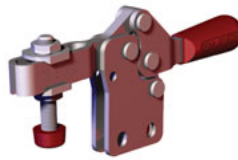
213-U
Flanged Base
U-Bar

213-USS
Flanged Base
U-Bar, Stainless
Steel

213-UB
Straight Base
U-Bar

213-U-L ⓘ
Flanged Base
Open Bar

213-UB-L ⓘ
Straight Base
Open Bar

Note:
Clamps shown with included accessories.

Series 213 Technical Information

Model	Max. Holding Capacity	Clamp Bar Opening (+10°)	Handle Opening (+10°)	Weight	Accessories (Supplied)	
					Spindle Assembly	Flanged Washers
213-U	670 N [150 lbf]	90°	60°	0,08kg [0.17lb]	213208-M	102111
213-USS					201943	102911
213-UB					213208-M	102111
213-U-L ⓘ					--	--
213-UB-L ⓘ					--	--

ⓘ This item is available upon request

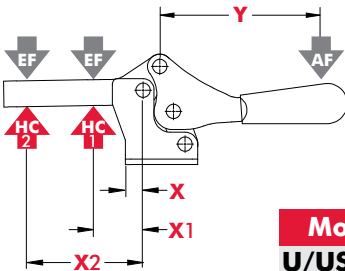
Series 213 Holding Capacities

Model	X	X1	X2	Y	‡HC1	‡HC2	‡EF(X1):AF	‡EF(X2):AF
U/USS/UB	[0.36]	[0.75]	[1.63]	[1.81]	[150lbf.]	[70lbf.]	7:1	3:1
U-L/UB-L	9,3	19	41,4	46	670N	310N		

Dimensions shown "mm [inch]" ‡ HC = Holding Capacity, EF = Exerting Force, AF = Applied Force
Refer to page 20.4 for additional information.

Series 213 Standard Clamp Dimensions
-U/-USS/-UB

213-U[†]
Flanged Base
U-Bar

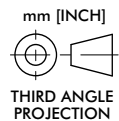
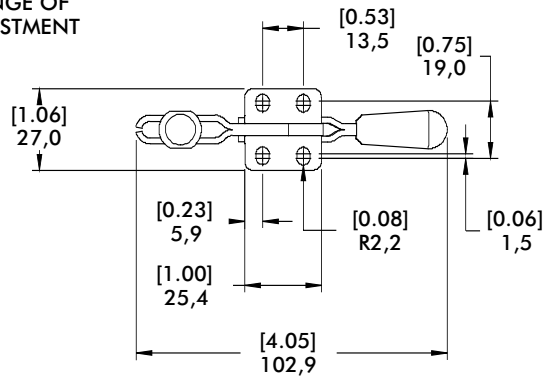
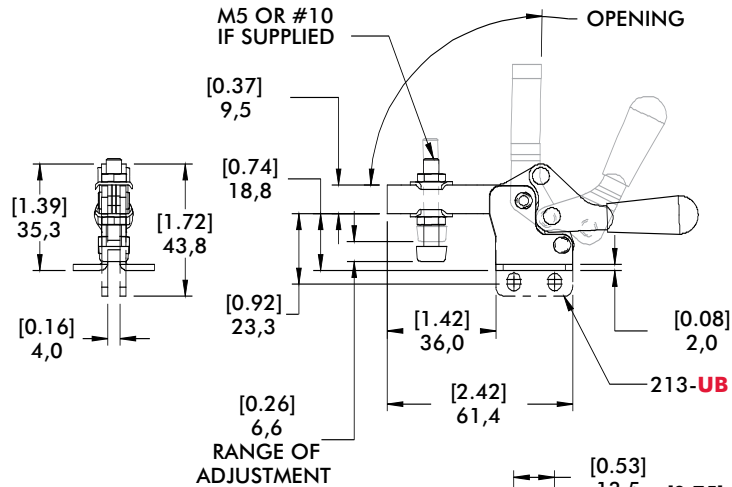
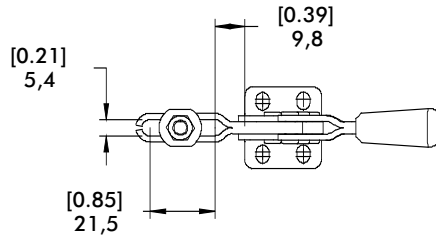
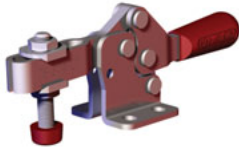

Series 213 Open Bar



Flanged Base
Model
213-U-L ⓘ

See page 8.7 for Complete offering of Open bar accessories

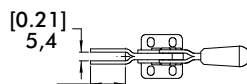

Straight Base
Model
213-UB-L ⓘ

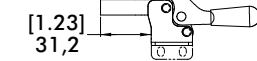

See page 2.14 for dimensions not shown