

Series 500 Product Overview

Features:

- Hardened pivot pins and bushings
- Weldable clamping bar
- LSC version with locking spring clip for securing the handle in the open position
- Modular design allows you to set up the clamp to meet application requirements

Applications:

- Welding
- Assembly
- Heavy duty, production clamping applications

Also Available:

See page 1.43 for accessories

501-**B** ⓘ
Swivel Base



501-**LB** ⓘ
Long Base

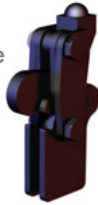

503-**MB**
Swivel Base



503-**MLB**
Long Base



503-**MBLSC** ⓘ
Swivel Base
with Locking
Spring Clip



503-**MLBLSCL** ⓘ
Long Base
with Locking
Spring Clip



505-**MB**
Swivel Base



505-**MLB**
Long Base



505-**MBLSC** ⓘ
Swivel Base
with Locking
Spring Clip



505-**MLBLSCL** ⓘ
Long Base
with Locking
Spring Clip



506-**MB**
Swivel Base



506-**MLB** ⓘ
Long Base



506-**MBLSC** ⓘ
Swivel Base
with Locking
Spring Clip



506-**MLBLSCL** ⓘ
Long Base
with Locking
Spring Clip



Model 505-MLB in a robotic welding fixture

ⓘ This item is available upon request

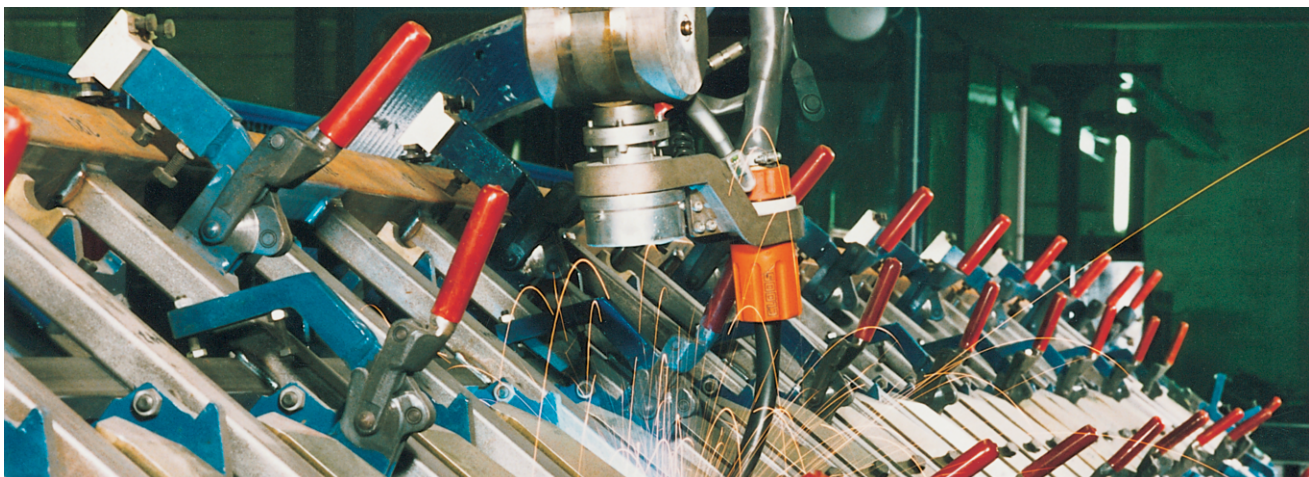

Series 500 Technical Information

Model	Max. Holding Capacity	Clamp Bar Opening (+10°)	Weight
501-B ⓘ	2000 N [450 lbf]	200°	0,18kg [0.40lbs]
501-LB ⓘ			0,20kg [0.44lbs]
503-MB	7000 N [1575 lbf]		0,70kg [1.54lbs]
503-MLB			0,80kg [1.76lbs]
503-MBLSC ⓘ			
503-MLBLSC ⓘ	0,90kg [1.98lbs]		
505-MB	11000 N [2475 lbf]		1,40kg [3.09lbs]
505-MLB			1,50kg [3.31lbs]
505-MBLSC ⓘ			
505-MLBLSC ⓘ			
506-MB	22500 N [5060 lbf]	2,60kg [5.73lbs]	
506-MLB ⓘ		2,80kg [6.17lbs]	
506-MBLSC ⓘ			
506-MLBLSC ⓘ			3,00kg [6.61lbs]

Note:

The clamping bars are made from forged alloy steel and must be heated to 200°C(400°F) prior to welding. We recommend welding the handles, clamp arms, and mounting bases when disassembled. Welding of non pre-heated parts may only be done with the addition of welding fillers.

ⓘ This item is available upon request

Clamping Position

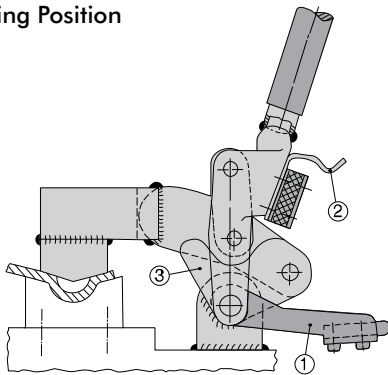

Patented spring latch hold-open device

1. Mount the clamp and place it in the closed position
2. Position the bracket ? in the leaf spring ?

Open Position

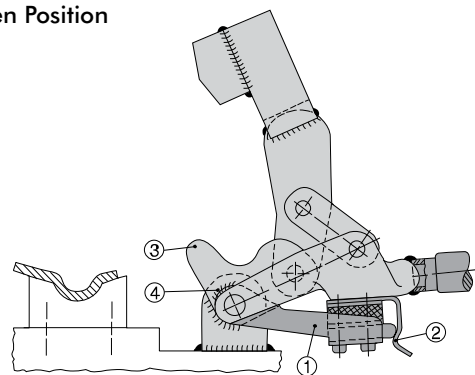

3. Swivel the clamp into the open position
4. In this position, weld the bracket ? with the bar guide feature ? at point ?

Series 500 Standard Clamp Dimensions
-B/-LB/-MB/-MLB/-MLBSC/-MLBLSC

Swivel Base

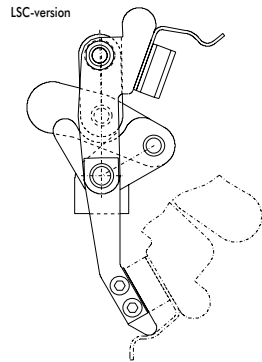
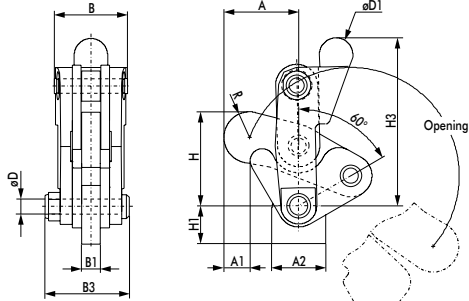

503-MB
Swivel Base



Long Base

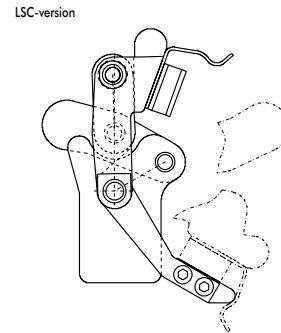
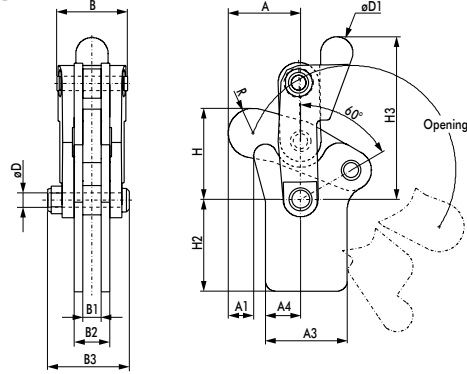

503-MLB
Long Base

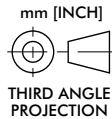

Swivel Base Dimensions

Model	A	A1	A2	B	B1	B3	ØD	ØD1	H	H1	H3	R
501-B ⓘ	[1.13] 28,6	[0.56] 14,3	[0.75] 19,1	[0.79] 20,0	[0.25] 6,4	[1.09] 27,8	[0.19] 4,8	[0.50] 12,7	[1.12] 28,5	[0.79] 20	[2.20] 56	[0.37] 9,5
503-MB	[1.54] 39,2	[0.50] 12,8	[1.12] 28,5	[1.52] 38,5	[0.39] 10	[1.82] 46,2	[0.31] 8	[0.69] 17,5	[1.96] 49,8	20	[3.51] 89,1	[0.53] 13,5
503-MBLSC ⓘ												
505-MB	[2.22] 56,5	[1.02] 25,9	[1.38] 35	[1.89] 48	[0.48] 12,3	[2.31] 58,6	[0.37] 9,5	[0.87] 22,2	[2.79] 70,8	[1.10] 28	[4.33] 110,1	[0.72] 18,3
505-MBLSC ⓘ												
506-MB	[2.82] 71,7	[1.27] 32,3	[1.97] 50	[1.91] 48,4	[0.63] 16	[2.72] 69	[0.47] 12	[0.94] 24	[3.45] 87,7	[1.29] 32,8	[5.30] 134,6	[0.84] 21,4
506-MBLSC ⓘ												

Long Base Dimensions

Model	A	A1	A3	A4	B	B1	B2	B3	ØD	ØD1	H	H2	H3	R
501-LB ⓘ	[1.13] 28,6	[0.50] 12,8	[1.13] 28,6	[0.56] 14,3	[0.79] 20	[0.25] 6,4	[0.51] 13	[1.09] 27,8	[0.19] 4,8	[0.50] 12,7	[1.12] 28,5	[1.32] 33,5	[2.21] 56,1	[0.37] 9,5
503-MLB	[1.54] 39,2	12,8	[1.75] 44,5	[0.75] 19	[1.52] 38,5	[0.39] 10	[0.79] 20	[1.82] 46,2	[0.31] 8	[0.69] 17,5	[1.96] 49,8	[1.97] 50	[3.51] 89,1	[0.53] 13,5
503-MLBLSC ⓘ														
505-MLB	[2.22] 56,5	[1.02] 25,9	[2.09] 53	[1.08] 27,5	[1.89] 48	[0.48] 12,3	[0.88] 22,3	[2.31] 58,6	[0.37] 9,5	[0.87] 22,2	[2.79] 70,8	[2.50] 63,5	[4.33] 110,1	[0.72] 18,3
505-MLBLSC ⓘ														
506-MLB	[2.82] 71,7	[1.27] 32,3	[2.58] 65,5	[1.45] 36,9	[1.91] 48,4	[0.63] 16	[1.10] 28	[2.72] 69	[0.47] 12	[0.94] 24	[3.45] 87,7	[3.00] 76,2	[5.30] 134,6	[0.84] 21,4
506-MLBLSC ⓘ														[8.43] 214