

Series 500 Product Overview

Features:

- Hardened pivot pins and bushings
- Weldable clamping bar
- LSC version with locking spring clip for securing the handle in the open position
- Modular design allows you to set up the clamp to meet application requirements

Applications:

- Welding
- Assembly
- Heavy duty, production clamping applications

Also Available:

See page 1.42 for accessories

501-**B** ⓘ  
Swivel Base



501-**LB** ⓘ  
Long Base



503-**MB**  
Swivel Base



503-**MLB**  
Long Base



503-**MBLSC** ⓘ  
Swivel Base  
with Locking  
Spring Clip



503-**MLBLSCL** ⓘ  
Long Base  
with Locking  
Spring Clip



505-**MB**  
Swivel Base

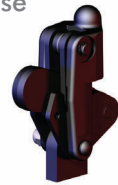

505-**MLB**  
Long Base



505-**MBLSC** ⓘ  
Swivel Base  
with Locking  
Spring Clip

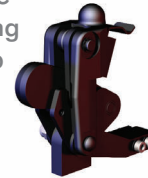

505-**MLBLSCL** ⓘ  
Long Base  
with Locking  
Spring Clip



506-**MB**  
Swivel Base



506-**MLB** ⓘ  
Long Base



506-**MBLSC** ⓘ  
Swivel Base  
with Locking  
Spring Clip

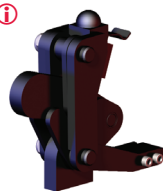

506-**MLBLSCL** ⓘ  
Long Base  
with Locking  
Spring Clip



Model 505-MLB in a robotic welding fixture

ⓘ This item is available upon request

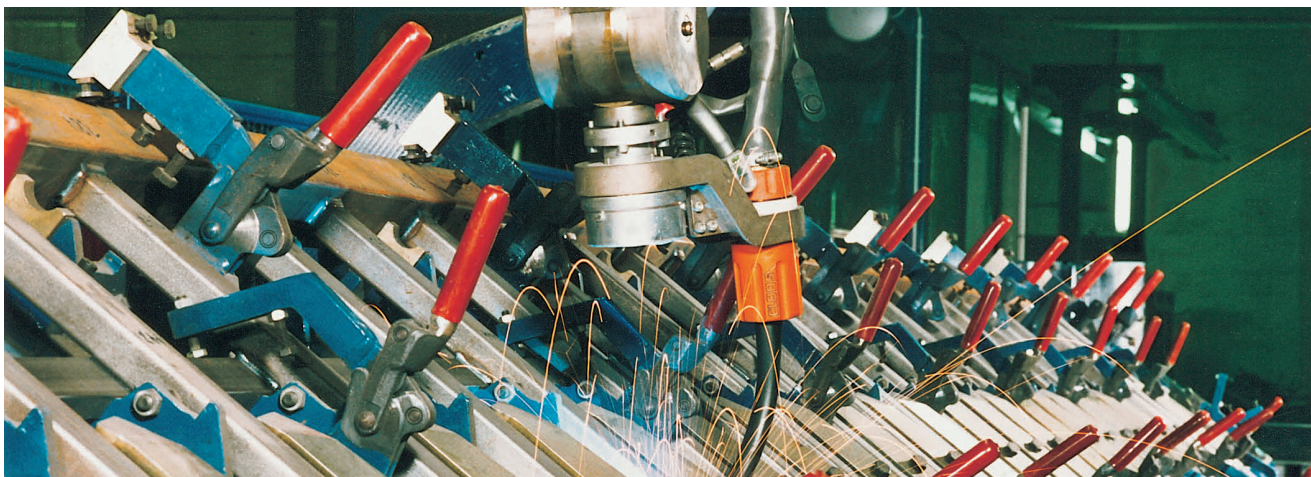

## Series 500 Technical Information

Model	Max. Holding Capacity	Clamp Bar Opening (+10°)	Weight
501-B ⓘ	2000 N [450 lbf]	200°	0,18kg [0.40lbs]
501-LB ⓘ			0,20kg [0.44lbs]
503-MB	0,70kg [1.54lbs]		
503-MLB	7000 N [1575 lbf]		0,80kg [1.76lbs]
503-MLBSC ⓘ			0,90kg [1.98lbs]
503-MLBLSC ⓘ			1,40kg [3.09lbs]
505-MB	11000 N [2475 lbf]		1,50kg [3.31lbs]
505-MLB			1,60kg [3.53lbs]
505-MLBSC ⓘ			2,60kg [5.73lbs]
505-MLBLSC ⓘ			2,80kg [6.17lbs]
506-MB	22500 N [5060 lbf]	3,00kg [6.61lbs]	
506-MLB ⓘ			
506-MLBSC ⓘ			
506-MLBLSC ⓘ			

**Note:**

The clamping bars are made from forged alloy steel and must be heated to 200°C(400°F) prior to welding. We recommend welding the handles, clamp arms, and mounting bases when disassembled. Welding of non pre-heated parts may only be done with the addition of welding fillers.

ⓘ This item is available upon request

Clamping Position

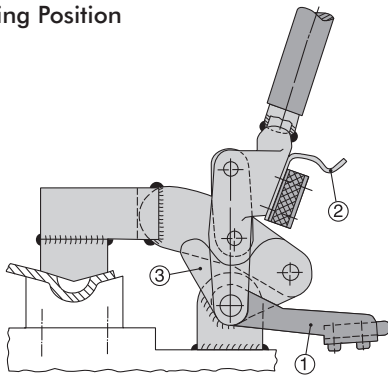

Patented spring latch hold-open device

1. Mount the clamp and place it in the closed position
2. Position the bracket ① in the leaf spring ②

Open Position

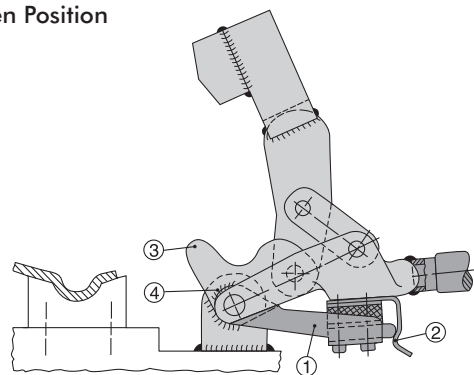

3. Swivel the clamp into the open position
4. In this position, weld the bracket ① with the bar guide feature ③ at point ④

Series 500 Standard Clamp Dimensions  
-B/-LB/-MB/-MLB/-MBLSC/-MLBLSC

Swivel Base

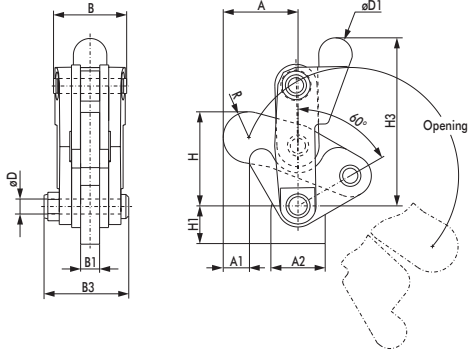

**503-MB**  
Swivel Base

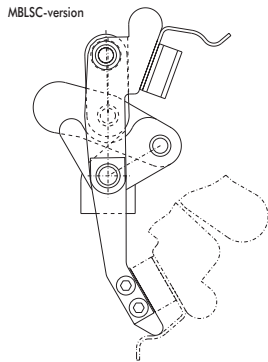

Long Base

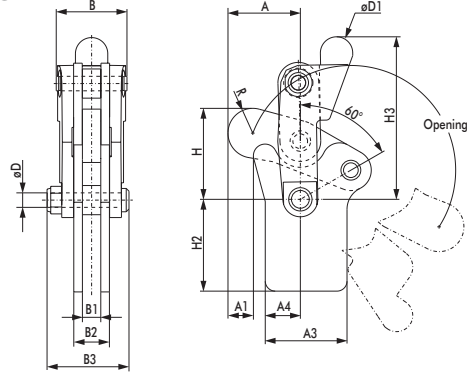

**503-MLB**  
Long Base

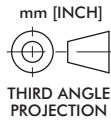
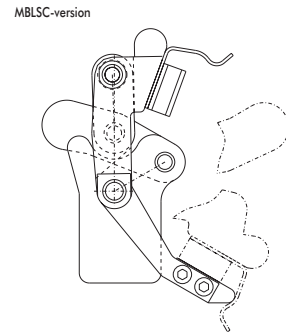

Swivel Base Dimensions

Model	A	A1	A2	B	B1	B3	ØD	ØD1	H	H1	H3	R
<b>501-B</b> ⓘ	[1.13] 28,6	[0.56] 14,3	[0.75] 19,1	[0.79] 20,0	[0.25] 6,4	[1.09] 27,8	[0.19] 4,8	[0.50] 12,7	[1.12] 28,5	[0.79]	[2.20] 56	[0.37] 9,5
<b>503-MB</b>	[1.54]	[0.50]	[1.12]	[1.52]	[0.39]	[1.82]	[0.31]	[0.69]	[1.96]	20	[3.51]	[0.53]
<b>503-MBLSC</b> ⓘ	39,2	12,8	28,5	38,5	10	46,2	8	17,5	49,8		89,1	13,5
<b>505-MB</b>	[2.22]	[1.02]	[1.38]	[1.89]	[0.48]	[2.31]	[0.37]	[0.87]	[2.79]	[1.10]	[4.33]	[0.72]
<b>505-MBLSC</b> ⓘ	56,5	25,9	35	48	12,3	58,6	9,5	22,2	70,8	28	110,1	18,3
<b>506-MB</b>	[2.82]	[1.27]	[1.97]	[1.91]	[0.63]	[2.72]	[0.47]	[0.94]	[3.45]	[1.29]	[5.30]	[0.84]
<b>506-MBLSC</b> ⓘ	71,7	32,3	50	48,4	16	69	12	24	87,7	32,8	134,6	21,4

Long Base Dimensions

Model	A	A1	A3	A4	B	B1	B2	B3	ØD	ØD1	H	H2	H3	R
<b>501-LB</b> ⓘ	[1.13] 28,6	[0.50]	[1.13] 28,6	[0.56] 14,3	[0.79] 20	[0.25] 6,4	[0.51] 13	[1.09] 27,8	[0.19] 4,8	[0.50] 12,7	[1.12] 28,5	[1.32] 33,5	[2.21] 56,1	[0.37] 9,5
<b>503-MLB</b>	[1.54]	12,8	[1.75]	[0.75]	[1.52]	[0.39]	[0.79]	[1.82]	[0.31]	[0.69]	[1.96]	[1.97]	[3.51]	[0.53]
<b>503-MLBLSC</b> ⓘ	39,2		44,5	19	38,5	10	20	46,2	8	17,5	49,8	50	89,1	13,5
<b>505-MLB</b>	[2.22]	[1.02]	[2.09]	[1.08]	[1.89]	[0.48]	[0.88]	[2.31]	[0.37]	[0.87]	[2.79]	[2.50]	[4.33]	[0.72]
<b>505-MLBLSC</b> ⓘ	56,5	25,9	53	27,5	48	12,3	22,3	58,6	9,5	22,2	70,8	63,5	110,1	18,3
<b>506-MLB</b>	[2.82]	[1.27]	[2.58]	[1.45]	[1.91]	[0.63]	[1.10]	[2.72]	[0.47]	[0.94]	[3.45]	[3.00]	[5.30]	[0.84]
<b>506-MLBLSC</b> ⓘ	71,7	32,3	65,5	36,9	48,4	16	28	69	12	24	87,7	76,2	134,6	[8.43] 214



### Features:

- Used with 500 Series Vertical Clamps
- Allows you to customize the clamp to suit application requirements

### Applications:

- Welding
- Assembly
- Heavy duty, production clamping applications

### Also Available:

See page 1.39 for clamp linkage

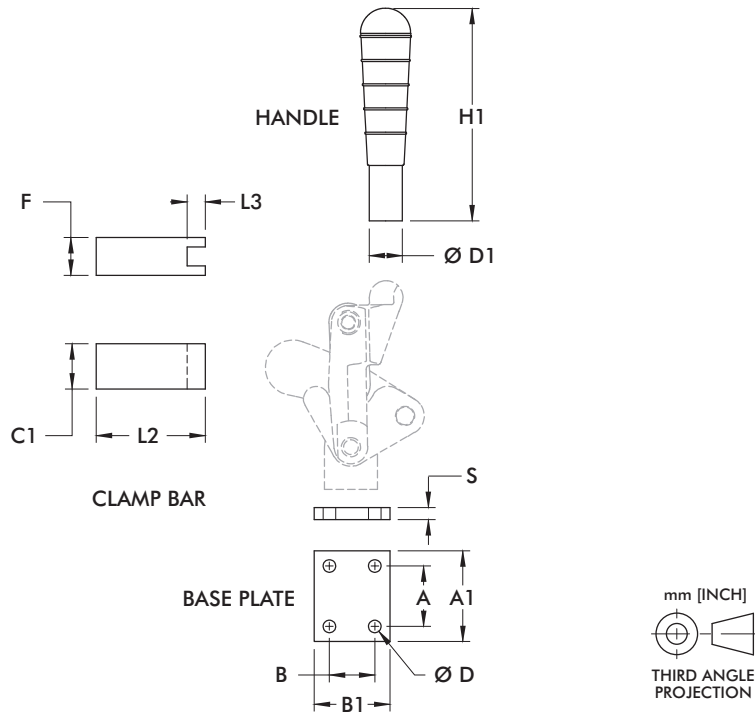

Use with	Part No.	Handle						Clamping Bar				Base Plate			
		ØD1	H1	C1	F	L2	L3	A	A1	B	B1	ØD	S		
501	501503 ⓘ	6x10	61	-	-	-	-	-	-	-	-	-	-		
	501501 ⓘ	-	-	15	15	40	10	-	-	-	-	-	-		
	503502	-	-	-	-	-	-	25	40	35	50	6.3	8		
503	503503-L	Ø18	129.5	-	-	-	-	-	-	-	-	-	-		
	503501	-	-	25	20	50	8	-	-	-	-	-	-		
	503502	-	-	-	-	-	-	25	40	35	50	6.3	8		
505	505503-L	Ø22	159	-	-	-	-	-	-	-	-	-	-		
	505501	-	-	30	25	60	12	-	-	-	-	-	-		
	505502	-	-	-	-	-	-	40	60	30	50	8.1	8		
506	506503-L	Ø28	188	-	-	-	-	-	-	-	-	-	-		
	506501	-	-	35	30	75	15	-	-	-	-	-	-		
	506502	-	-	-	-	-	-	50	70	45	65	8.1	8		

ⓘ This item is available upon request Note: Dimensions shown in millimeters.